

# **Milwaukie High School Remodel**

## **Frequently Asked Questions**

### **When does construction start? When will it be completed?**

Demolition of the main building is tentatively scheduled to begin around June 2018 and new construction is tentatively scheduled to be completed around Fall 2021.

### **Where will the students go?**

The classrooms from the main building, including campus security and restrooms, will be replaced by modular buildings that will be added on the stadium field. Modular set-up is tentatively scheduled to start before summer 2018 and classroom furniture and materials will be moved into them as soon as school is out in June. During construction, students will continue to have access to the classes in the gymnasium and the performing arts building which houses music, art and drama. The services provided in the Administration office and commons will also continue, although some remodel may alter access to areas of the administration offices at times. In addition, the Student Health and Wellness Center will move to a temporary location onsite to continue service to students.

### **What will happen to the athletic fields?**

The varsity softball field will be used for construction staging. While the softball field is being built permanently with artificial turf on the Lake Road complex, the team will have use of the field on Alder Creek campus. Transportation will be provided.

The main stadium will be closed for athletics during the construction of the main building as it will house numerous modular classrooms. The stadium at Alder Creek Middle School will be Milwaukie's home stadium during this time. The turf on MHS campus will be replaced upon removal of the portables as part of the bond commitments.

### **How was the new design developed?**

The district hired an architect firm, Dull Olson Weekes-IBA Group. A Design Team of 23 members was formed, including teachers, classified staff, community members, district representatives, school administration and a student. They met multiple times over the course of 6 months. The guiding principles were to:

1. create a unified campus that incorporates the commons/administration building into the design
2. create modernized learning spaces
3. create spaces with natural light
4. build a safe and healthy environment for generations of students to come.

The team visited other remodeled or new schools in the area, developed ideas around the needs of students and conducive learning spaces. Given the input from the Design Team over these months, as well as meeting with focus groups of staff numerous times, the architects developed several options to meet the guiding principles. Community Forums were held for additional input.

**Why is it being demolished? Why didn't you keep the shell of the building and just remodel the rest?**

This sounds easier than is actually possible and a very costly endeavor. Millions of dollars of this project would have had to go into the seismic upgrades needed to make the main building safe, leaving less money for the main focus of the project-- to meet the needs of the students.

There are other architectural challenges as well. The first floor of the building is actually the original basement. The stairs were originally built to enter on the second floor as shown in the picture below.



1956



Current

The stairs were removed in 1958 and the new entrance was created at ground level. This first floor is not a full height floor. New construction and fire codes require much more space between floors to install ductwork for ventilation and wiring for new technology. This requires the floors to be at different heights than the the current facade would allow.

In addition, the commons and administration building that were added in 1993 creates a confusing labyrinth of stairwells and mezzanine corridors to both the main building and the gym. One of the major goals identified by the Design Team early on in this project was to make the transition between the commons building and the main building a seamless one. Keeping the shell of the original school building would not have met this goal.

A full survey of the building was conducted by structural engineers and the architect. Their [recommendation can be read here.](#)

### How will the new design honor the history of Milwaukie?

The architects have collected various old photographs, completed walkthroughs of the building to see what architectural and material components may be repurposed in the new building. Here are just a couple of ideas being considered. We will post more as they get farther along in that process.

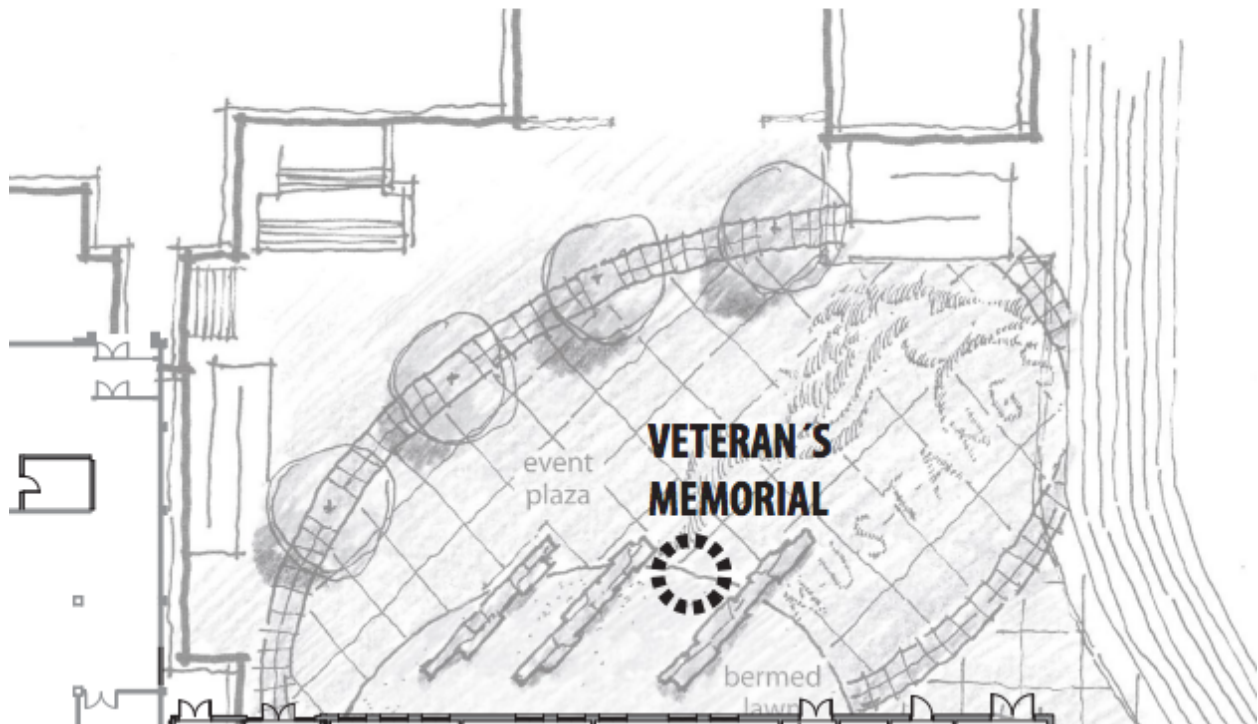

*Potential event plaza located between the main building and the gym.*

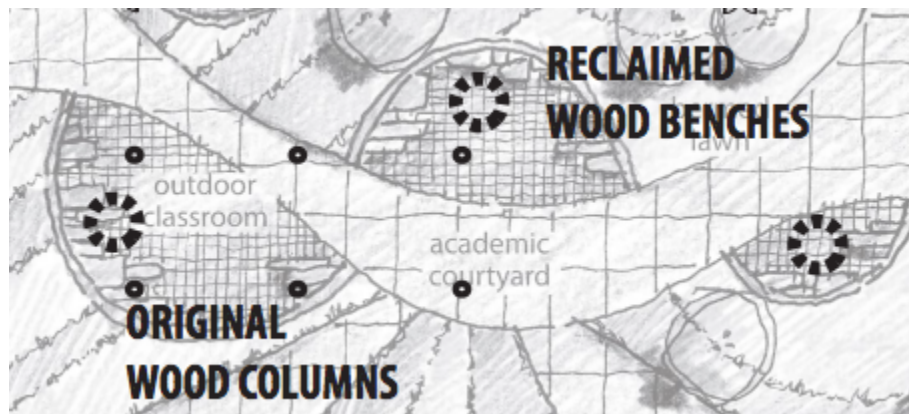

*Center courtyard: use of reclaimed wood from the original building construction.*

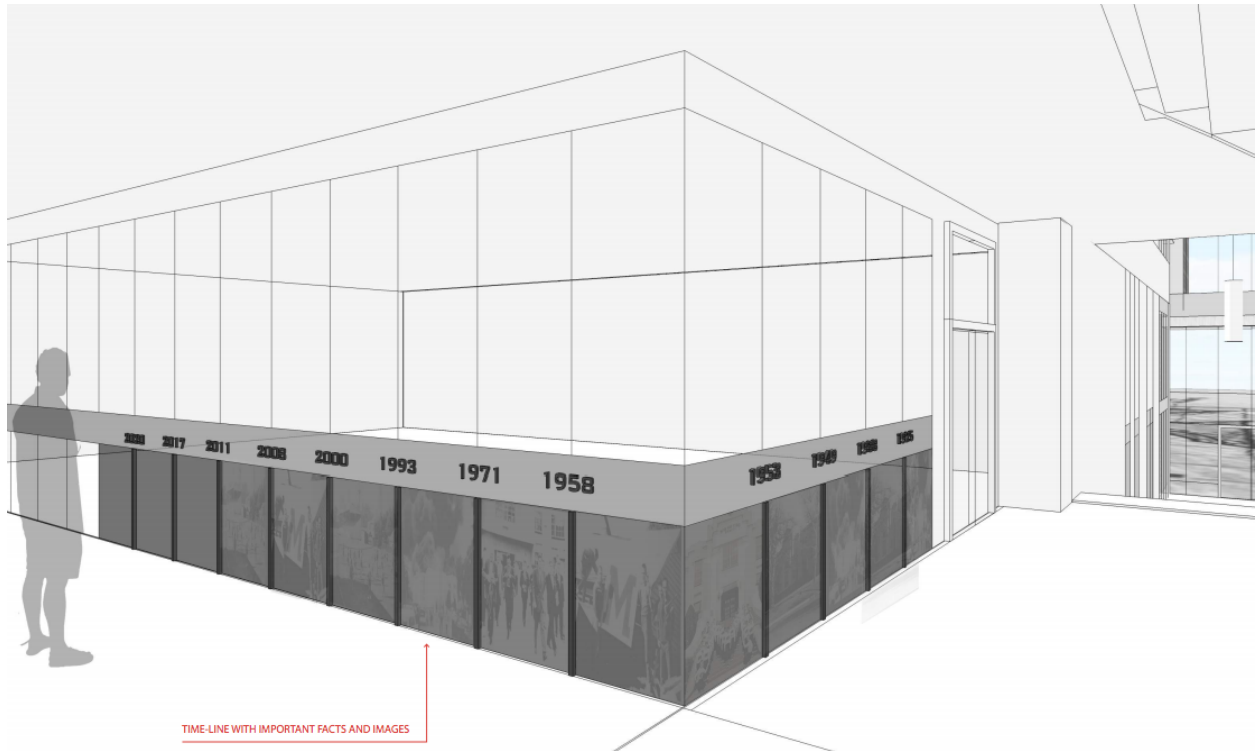

*Timeline of the history of Milwaukie High in main hallway.*



*Historic Wall displaying past images.*

### What will happen to the big trees?

We have an arborist looking at the health of the trees. We know that one will have to be removed, but we are hopeful to keep the rest and incorporate them into the landscape design. You can see what the front courtyard may look like in an early conceptual plan. The green space in the front represents keeping some of the current trees.

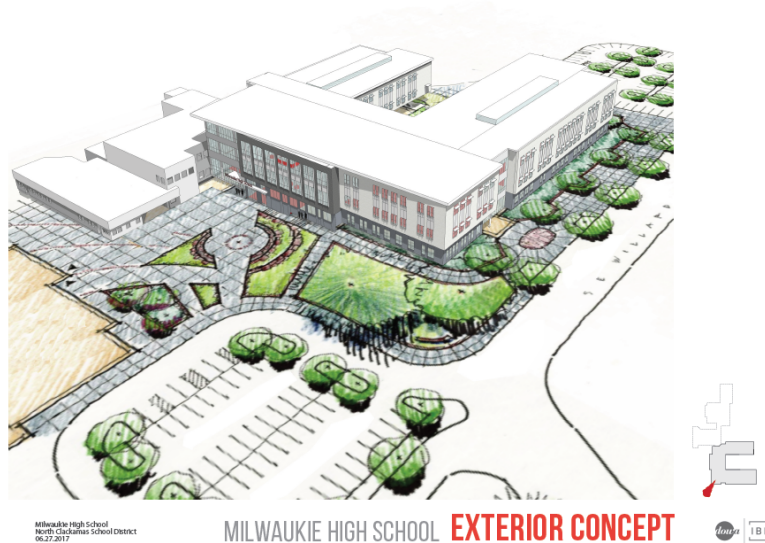

### Will there be more parking when the project is complete?

Yes. The current varsity softball field that will be used during construction for contractor staging will be converted into a parking lot at the end of construction. In addition, the tennis courts may be relocated to Rowe Middle School where Milwaukie tennis teams will play. This space could allow for additional parking as well.

